



PGMS Reopening Town Hall

PGMS Principal Sean Roach
Assistant Principal Jason Tovani
March 16, 2021



Purpose of our Meeting

1. Describe our Hybrid and Distance Learning programs to help families choose the best instructional model for their children
2. Explain Reopening factors
3. Explain covid safety protocols in place at PGMS
4. Answer questions to the best of our ability.



Why we can reopen now

Grade levels 7-12, as well as middle schools serving grades 6-8, are permitted to open when California enters the Red Tier

Today's Tier assignment is Red!



Primary considerations for planning in-person instruction

- Safety of students and staff
- Maintain as much continuity as possible throughout the transition to in-person schooling
 - Avoid re-rostering, if possible
 - Continue use of Google Classroom as the platform for class assignments and materials
 - Stick with the same bell schedule (evens/odds), if possible
- Develop a program and schedule that can support both in-person and remote learning



Pending Board Approval

Current board approved secondary reopening date is April 19th

If the board approves an earlier reopening date, our recommendation is:

- April 6/7- Teacher Preparation (asynchronous learning)
- April 8/9- 6th grade only (training & orientation)
- April 19- New to PGMS orientation on site
- April 20- 6th/7th grade only (training for 7th)
- April 21- All grade levels 6-8 (training for 8th)



Parent Survey

Sent out Wednesday, March 3

Due back by Thursday, March 18th, 5pm (but, sooner is better!)
If you need to change your response please email Mr. Tovani

Complete one survey per child

Two choices:

- In-person learning (Hybrid) program
- Full distance learning program

➡ It is expected that families will continue with their choice through the end of the year.



Distance Learning Program

This is a continuation of the current instructional program:

- Students continue to do all learning from home through Google Classroom and Google Meets
- Students access daily live instruction via Google Meets sessions broadcast from the classroom
- Daily live interaction with teachers and peers
- Instruction is computer based, however traditional learning materials may still be used, such as notebooks, journals, paper & pencils, etc.
- Combination of synchronous (live) and asynchronous (recorded) instruction
- Teacher remains the same
- Students will be rostered to either the AM group or the PM group, and follow the schedule for their group
- All students with a first period PE or AVID will be rostered to the AM group



In Person Learning (Hybrid) Program

Current classes are split in half to accommodate Covid safety guidelines for social distancing:

- Students attend school in AM/PM shifts; campus and classes are at 50% capacity
 - Alphabetical split for AM/PM designation
- Students attend for four half-days each week
 - Mondays continue to be asynchronous, with Advisory class 10:10-10:45
- AM group attends school in the morning, and works asynchronously in the afternoon
- PM group attends school in the afternoon, and works asynchronously in the morning



In Person Learning (Hybrid) Program (cont.)

- Students attend three classes per day, either periods 2, 4, 6 or 3, 5, 7
- Instruction is computer based, with slight modifications possible for in-person students.
- Students will be rostered to either the AM group or the PM group, and follow the schedule for their group
- All students with first period PE and AVID will be rostered to the AM group



In Person Learning (Hybrid) Program (cont.)

What to expect

Teaching in a classroom where students must remain socially distanced significantly limits what is possible in the classroom. Essentially, Covid hybrid education will look quite similar to our current distance learning model. Teachers and students will continue to utilize Google Classroom, and various other technologies as they have all year (Peardeck, Edpuzzle, Google Meets) with the difference being that the on-site students will be physically in class with their teacher of record. This continuity of learning will ease the transition for both students and teachers.



Special Education

Special education students will receive “pull-out” services remotely (speech, occupational therapy, specialized academic instruction, etc.)

Instructional aides will support special education students in the classroom (hybrid) and online (DL only), in both AM and PM groups.



Chromebooks

Our plan for Chromebooks is to have our Hybrid students return them to school IF they have their own technology at home to use for asynchronous learning. Distance Learning students will keep their Chromebooks at home to participate in state testing. Students will not be transporting Chromebooks to and from school



Weekly Schedule

	Monday	Tuesday	Wednesday	Thursday	Friday
AM/PM Model	Teacher Planning, Advisory & DL	AM Group (PM Asynchronous)	AM Group (PM Asynchronous)	AM Group (PM Asynchronous)	AM Group (PM Asynchronous)
		PM Group (AM Asynchronous)	PM Group (AM Asynchronous)	PM Group (AM Asynchronous)	PM Group (AM Asynchronous)



School Day for AM & PM Groups

AM Group

Start of school: 8:30 am*

Dismissal: 11:30am

3 classes, 50 minutes each

*Period 1 classes (PE, AVID 7)
7:35-8:15am, 2 days/week

PM Group

Start of school: 12:30 pm

Dismissal: 3:30

3 classes, 50 minutes each

Choir & Period 8 Jazz Band are Virtual only, Mondays

Bell Schedule for Hybrid & Full DL Students

PGMS Hybrid Learning Schedule

AM/PM Split

	Monday		Tuesday	Wednesday	Thursday	Friday	
7:45- 8:25	Period 1*		Period 1 (Group 1)	Period 1 (Group 2)	Period 1 (Group 1)	Period 1 (Group 2)	
8:30- 9:10	Period 2		Period 2A	Period 3A	Period 2A	Period 3A	Synchronous Instruction Group A
9:20- 10:00	Period 3		Break (15)		Break (15)		Synchronous Instruction Group B
10:10- 10:45	Advisory		Period 4A	Period 5A	Period 4A	Period 5A	Breaks
10:45- 11:00	Break		Break (15)		Break (15)		Advisory (All Students A/B together)
11:00- 11:40	Period 4	Period 8 Jazz Combo 11:00-12:20 (Virtual)	Period 6A	Period 7A	Period 6A	Period 7A	Asynchronous schedule (optional)
11:50- 12:30	Period 5		Cohort A Dismissal Grab & Go Lunch Disinfect Classrooms Cohort B Arrival		Cohort A Dismissal Grab & Go Lunch Disinfect Classrooms Cohort B Arrival		
12:30- 1:15	Lunch		Period 2B	Period 3B	Period 2B	Period 3B	
1:15- 1:55	Period 6	Choir (Virtual) 1:15-2:35	Break (15)		Break (15)		
2:05- 2:45	Period 7		Period 4B	Period 5B	Period 4B	Period 5B	
			Break (15)		Break (15)		
			Period 6B	Period 7B	Period 6B	Period 7B	



Asynchronous learning in hybrid model

Instructional Minutes*	Synchronous	Asynchronous	Total
6th - 8th	100 min/week	140 min/week	240 min/week

*Applies to both in-person and full DL programs



Lunch

All students will be provided a “grab-n-go” lunch as they *leave* campus

- AM students will eat their lunch the same day
- PM students will eat their lunch the following day

Lunches will be provided at no cost to families

There will be no a la carte items available

All students will wash hands or use hand sanitizer before and after lunch



Student drop off and pickup

- Students may arrive on campus up to 15 minutes prior to the start of their day.
- Students must head directly to their assigned point of entry, and wait in the designated area to be let in the building.
- Students will be assigned a campus entrance in close proximity to the location of their first class of the day.
- Students must leave campus immediately after their school day ends; no hanging out on campus.



Student drop off and pickup (cont.)

- Students will be checked for symptoms and have temperatures taken at their assigned point of entry. Parents will be contacted for students with a fever of greater than 100.4 degrees.
- Students will be monitored as they move into and out of the building in order to ensure that safety protocols (social distancing, mask wearing, etc.) are being followed.
- Parents & visitors will not be allowed on campus before, during, or after school.

*Six access points (Entrances)
*Each access point is assigned to students from specific classrooms in that area of the school.



All halls are **one way** during passing periods

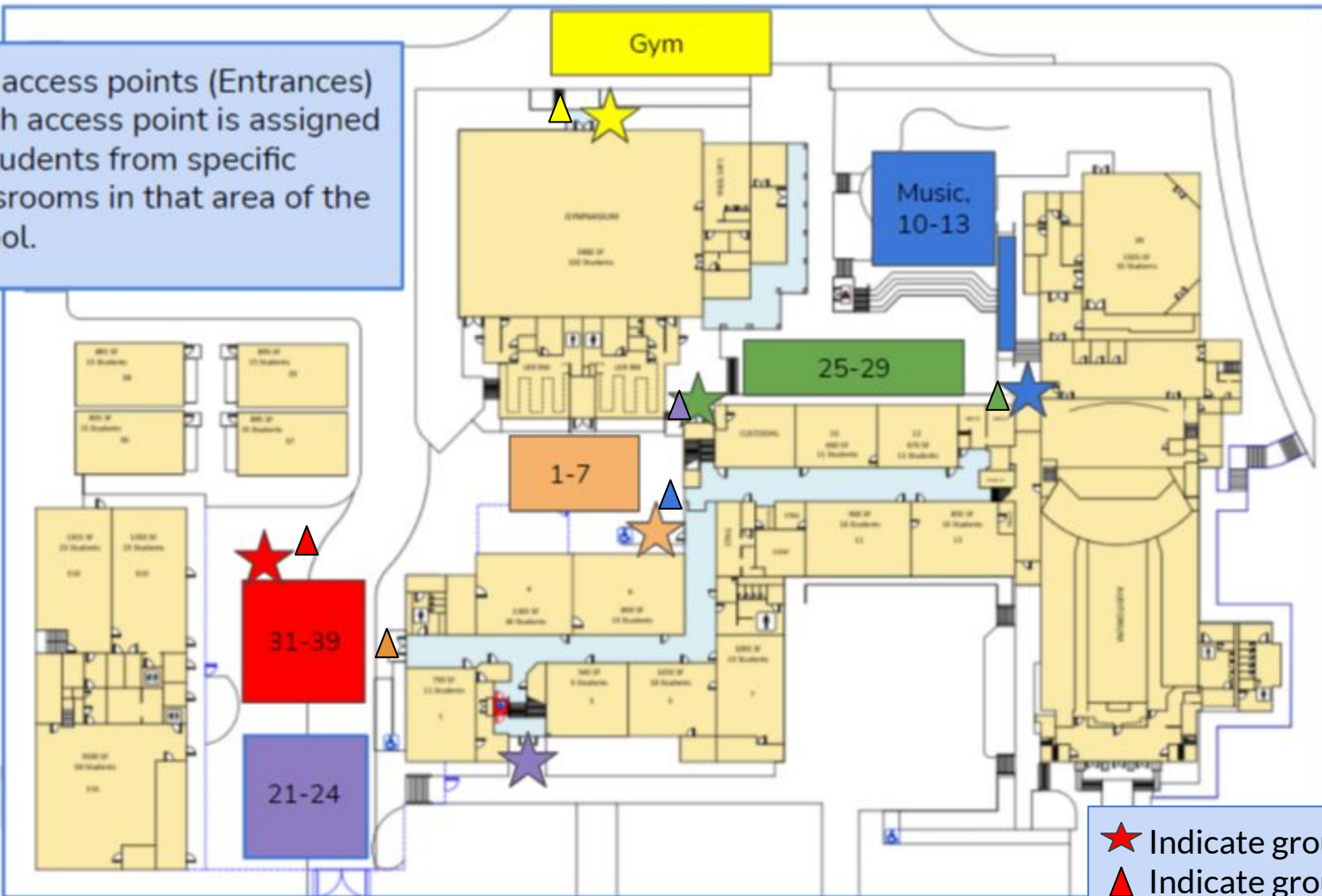

★ Indicate group entrance
▲ Indicate group exit

Assigned entrances for each class

Students waiting to be screened wait near their assigned entrance

Colored dots represent adequate physical distance

Signage indicates which rooms can be accessed by each entry



Restrooms



- Students will use common restrooms with particular stalls assigned to each grade level
- Students will be allowed in restrooms two at a time during passing periods
- Students may access restrooms during class periods
 - Teachers will notify the office when a student is released from class to use the restroom



Transportation

Families should plan on transporting students to school

Busing is not available at this time*

*Exception - Special education students who require transportation as a related service as per their IEP's.



Safety procedures

[PGUSD Covid Safety Plan](#)

Wellness check

Room cleaning

Face covering

Air flow/HVAC

Hand washing

Sick student

Physical distancing

Covid case

We are all in this together. Failure to comply with safety procedures may result in a student having to return to Distance Learning Only.



Face coverings

Covid Safety Plan p. 29

All students and staff who are able must wear face coverings

Staff will have extra masks available for students who forget to bring one or damage theirs

Face shields are not a substitute for masks

Students will be reminded how to properly wear a mask if they are not doing so



Handwashing

Students wash hands or use hand sanitizer every time they enter or exit a classroom

Handwashing stations that allow for physical distancing have been installed around campus.

Students will be reminded how to properly wash their hands repeatedly

Handwashing station





Physical Distancing

Students and staff are to maintain six feet of separation as much as practicable

All buildings and classrooms have been evaluated to determine the max number of students each space can hold while maintaining social distancing

Students are seated six feet apart in all classrooms

Staff will supervise all hallways and waiting areas at all passing periods to remind students to maintain 6ft of physical distance.

Physically distancing in the classroom



Physical distancing in the classroom



One way hallways

All hallways are one way during passing periods

During class time, hallways are two-way, to help students get to and from restrooms as quickly as possible

Teachers will notify the office when a student is released to go to the bathroom

All students will exit the building after each class

Lockers will not be used; students can bring backpacks from class to class.



A photograph of an outdoor paved area with orange safety cones placed in a grid pattern. A green arrow points from this area towards the entrance of the building.

1. Assigned entry



Putting the pieces together: Going to class



Room cleaning

Covid Safety Plan, p. 40

Classrooms will be disinfected between A.M./P.M. session and before A.M. class

High touch surfaces will be wiped down throughout the day

Classes will have microfiber cloths and hydrogen peroxide provided for additional spot cleaning

Electrostatic sprayers used to disinfect classrooms and play structures.

Nanotechnology applied to each classroom - effective for 90 days



HVAC

- Increase the flow of fresh outdoor air
 - Opening windows and doors to create cross air movement
 - Run HVAC fans between heat cycles
 - Maximize fresh air intakes on HVAC units
- Estimated Air Changes an Hour (ACH)
 - ACH - is the measure of how many times the air within a defined space is replaced each hour
 - 5-Step Guide to Checking Ventilation Rates in Classrooms
 - Harvard T.H.Chan School of Public Health
 - Estimate the outdoor air ventilation rate using the CO2 decay method

HVAC



HEALTHY BUILDINGS

FOR HEALTH



HARVARD T.H. CHAN
SCHOOL OF PUBLIC HEALTH

TARGET IS AT LEAST 5 TOTAL AIR CHANGES PER HOUR



HVAC

School PGMS
Room 6
Date 3/15/2021

Peak Concentration = 2407 ppm
 Outdoor Concentration Start 400 ppm
 Target (37% Concentration) 1142.59 ppm

C-start 2407 ppm
 T-start 0:00:00
 C-end 1142.59 ppm
 T-end 0:08:09
 Outdoor Concentration End 400 ppm
 C-ambient 400 ppm

C-end - C-ambient 742.59 ppm
 C-start - C-ambient 2007 ppm
 T-end - T-start [mm:ss] 0:08:09

Air Changes an Hour (ACH) 7.5
 Ideal

PGMS - Room 6

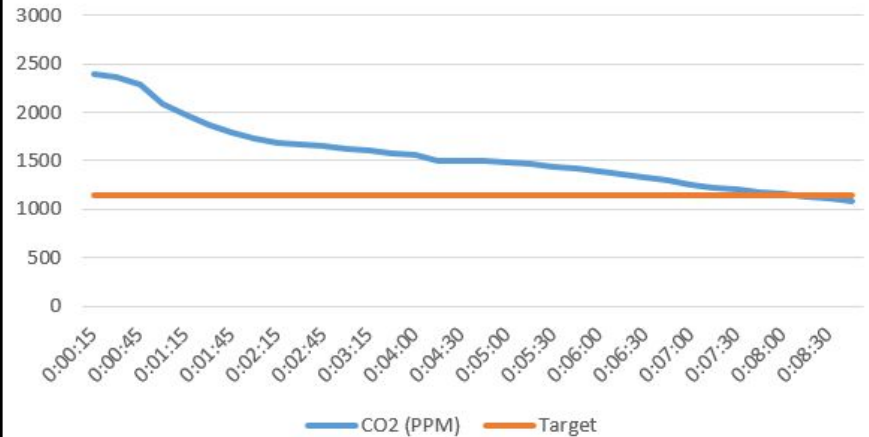

Field Notes: Lower level classroom. Windows open, door open to hallway, one exterior door open, unit fan on.

HVAC

School	PGMS
Room	25
Date	3/15/2021
Peak Concentration =	2236 ppm
Outdoor Concentration Start	398 ppm
Target (37% Concentration)	1078.06 ppm
C-start	2236 ppm
T-start	0:00:00
C-end	1078.06 ppm
T-end	0:03:00
Outdoor Concentration End	398 ppm
C-ambient	398 ppm
C-end - C-ambient	680.06 ppm
C-start - C-ambient	1838 ppm
T-end - T-start [mm:ss]	0:03:00
Air Changes an Hour (ACH)	19.9 Ideal

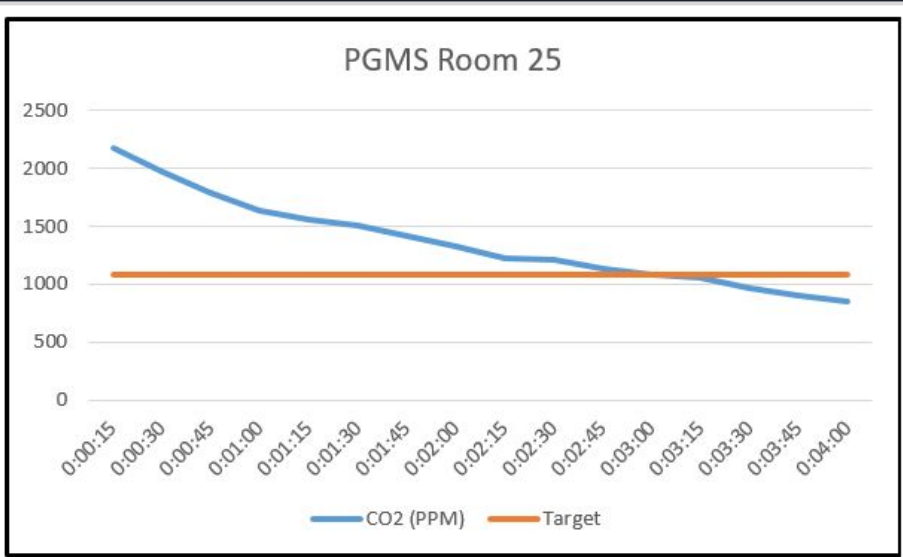

Field Notes: Upper level classroom. Windows open, door open to hallway, exterior hallway windows open, unit fan on.

Wellness Check

Covid Safety Plan p. 14

Temperature & symptom check prior to entering any school building

Monitor throughout the day for symptoms: Headache, chills, cough, sore throat, congestion (not related to allergy or asthma), new loss of taste or smell, difficulty breathing (not related to asthma), muscle or body aches, stomach ache, diarrhea, or fatigue

If a student shows symptoms before coming to school, parents should keep the student home





Student with symptoms

Covid Safety Plan, p. 11

Staff contacts office and health clerk who escorts student to designated area

School contacts parent to pick up the student

Parent will be instructed to keep student at home until no signs or symptoms of illness for at least 24 hours without over-the-counter medication.

Family consults with health care provider for evaluation and to determine if testing is needed

*Please update student health records at school (ie - seasonal allergies can present as infectious disease symptoms)



Confirmed Covid case

Covid Safety Plan p. 12 & 17

District nurse contacted - she begins assembling list of possible close contacts for tracing

Exposed area closed for 24 hours - disinfected before next use.
Administrators work with health officials to support contact tracing and determine level of exposure

Close contacts are notified, advised to quarantine for 14 days, advised to contact healthcare provider

Members of student's household advised to quarantine for 14 days
* A student in quarantine will continue to attend school via distance learning

Student returns to school after meeting criteria to end quarantine



PGMS Town Hall Presentation

That concludes our presentation. Please “raise” your hand if you would like to ask us a question and state your name. We will try to get to as many questions as possible.